

## ACETAL CASE CHAINS

## PM1400 / PM1400D

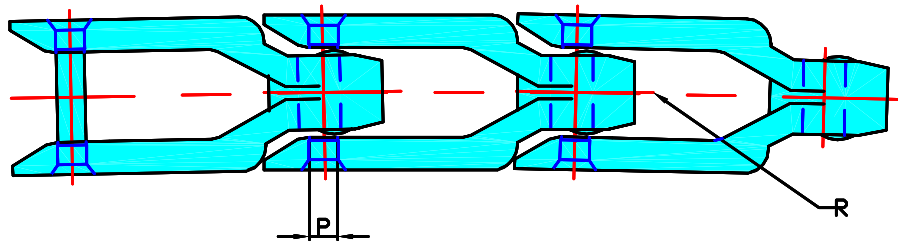
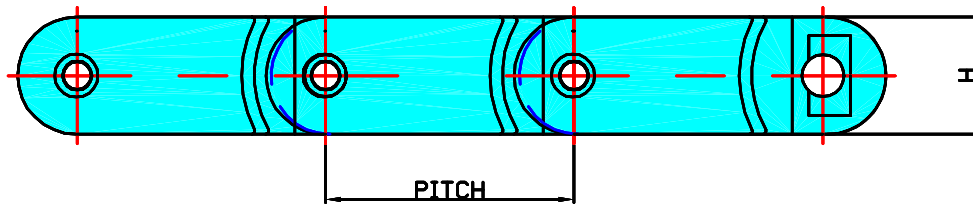

### STANDARD TYPE

### D TYPE

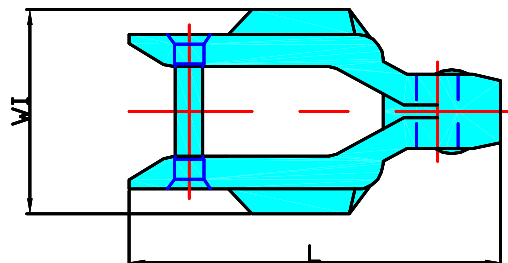
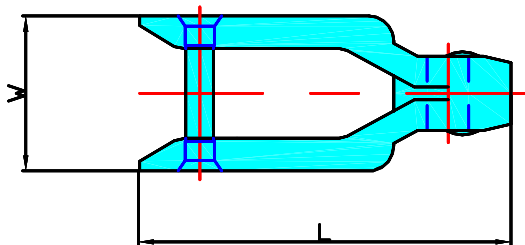
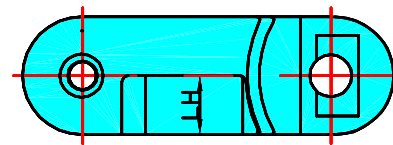
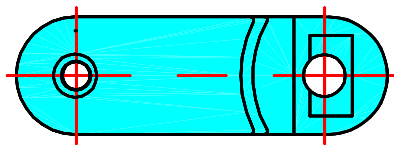

TRAVEL

TRAVEL

CHAIN N°	PITCH		P		PIN TYPE	L		W		WI		H		LH		R	CHAIN wt/m	UTS	MAX LOAD	
	in	mm	in	mm		in	mm	in	mm	in	mm	in	mm	in	mm					in
PM1400	3.25	82.55	0.44	11	S,C,R	4.85	118.10	2.0	50.80	-	-	1.50	38.1	-	-	26	660	2.08	2265	1200
PM1400D	3.25	82.55	0.44	11	S,C,R	4.85	118.10	2.0	50.80	2.625	66.68	1.50	38.1	0.75	19.05	26	660	2.27	2265	1200

Pin types: S- Snap in, C-Circlip, R-Rivet



(UK) John King Chains Limited.  
 New Climax Works, Lancaster Way, Sherburn in Elmet LS25 6NS UK  
 Telephone: (44) 01977 681910 Facsimile: (44) 01977 681899  
 E-mail: admin@johnking-chain.com  
 technical@johnking-chain.com  
 sales@johnking-chain.com

John King (USA) Inc.  
 200 Catherine Street, Unit 7B, E. Peoria IL61611 USA  
 Telephone: 309-698-9250 Facsimile: 309-698-9259  
 E-mail: salesusa@johnking-chain.com

Web: www.johnkingchains.com